

From: Warnett, Mark <Mark.Warnett@carterjonas.co.uk>
Sent: 18 March 2020 20:01
To: Jones, Hefin <HEFIN.JONES@planninginspectorate.gov.uk>; Fletcher, Ian (Winnersh) <Ian.Fletcher2@jacobs.com>; Anstee De Mas, Jonathan N <jonathan.n.ansteademas@exxonmobil.com>; [REDACTED] Helen Forbes <Helen.Forbes@surreycc.gov.uk>; Clare Springett <Clare.Springett@surreycc.gov.uk>; David Moody <David.moody@brutonknowles.co.uk>
Cc: Southampton to London Pipeline Project <SouthamptontoLondonPipeline@planninginspectorate.gov.uk>; Johansson, KJ <KJ.JOHANSSON@planninginspectorate.gov.uk>
Subject: RE: URGENT - Southampton to London Pipeline Project: Site Inspection Tomorrow

Dear Hefin

Thank you for your email.

With apologies for the late notice, but given the inspection is unaccompanied, St James' school would ask the ExA note the position of the following:

- the consented Assembly Hall development
- proposed all weather pitch
- sports hall development

These are shown on the attached plans (which were previously submitted as part of the School's representations). I would note that the Applicant's Working Area has been amended from these plans (in accordance with the Site Specific Plan No.2) however the position of the proposed developments have not changed, nor I believe have the Order Limits.

I trust this is in order.

Regards

Mark

Mark Warnett MRICS FAAV
Partner

Carter Jonas

T: 020 7518 3246 x2783 [REDACTED] | carterjonas.co.uk
One Chapel Place, London, W1G 0BG

Response to Coronavirus / Covid-19



INVESTORS
IN PEOPLE

Gold
Until 2022



 Please consider the environment. Do you really need to print this email?

From: Jones, Hefin <HEFIN.JONES@planninginspectorate.gov.uk>

Sent: 18 March 2020 14:47

To: Fletcher, Ian (Winnersh) <Ian.Fletcher2@jacobs.com>; Anstee De Mas, Jonathan N <jonathan.n.anstedemas@exxonmobil.com>; Warnett, Mark <Mark.Warnett@carterjonas.co.uk>;

 Helen Forbes <Helen.Forbes@surreycc.gov.uk>; Clare Springett <Clare.Springett@surreycc.gov.uk>; David Moody <David.moody@brutonknowles.co.uk>

Cc: Southampton to London Pipeline Project

<SouthamptontoLondonPipeline@planninginspectorate.gov.uk>; Johansson, KJ

<KJ.JOHANSSON@planninginspectorate.gov.uk>

Subject: [Ext Msg] URGENT - Southampton to London Pipeline Project: Site Inspection Tomorrow

Importance: High

Dear all,

In order to comply with the most recent government advice regarding social distancing, the Planning Inspectorate has advised that where possible all Accompanied Site Inspections (ASIs) should be done on an unaccompanied basis or where arrangements can be made to allow the Inspectors access to the site in a way that avoids social contact. As a result, the ASI that was due to be undertaken tomorrow at St James Senior Boys' School will now be undertaken on an unaccompanied basis with the Examining Authority (ExA) being escorted, whilst on the school grounds, by a member of the school staff, solely for the purposes of safeguarding.

Please therefore note that all Interested Parties that had previously confirmed attendance should not attend.

The ExA will publish a detailed Unaccompanied Site Inspection note of the visit as soon as practicable after the event.

We have received submissions from the Applicant and Surrey County Council pointing out features that they wish for the ExA to observe. These have been treated as Additional Submissions and published on the project page. The ExA will take these submissions into account when carrying out the visit.

The ExA will be in possession of the following documents during the course of the visit:

- **General Arrangement Plan** (sheet 122) [REP4-005]
- **Site Specific Plan – St James' School Revision No. 2.0** (March 2020) [REP6-061]
- **St James Senior School, Ashford Esso's Southampton to London Pipeline project – Comments on Applicant's and School's alternative pipeline routes prepared for St James School** (January 2020) [REP4-082].

I hope this is of assistance but please do not hesitate to contact me if you require any further information.

Kind regards,

Hefin

Hefin Jones

Rheolwr Achos / Case Manager

Cynllunio Seilwaith Cenedlaethol / National Infrastructure Planning

Yr Arolygiaeth Gynllunio / The Planning Inspectorate, Temple Quay House,
Temple Quay, Bristol, BS1 6PN

Llinell Uniongyrchol / Direct Line: 0303 444 5944 neu/or 07407877938

Llinell Gymorth / Helpline: 0303 444 5000

E-Bost / Email: hefin.jones@planninginspectorate.gov.uk

Wê / Web: <https://infrastructure.planninginspectorate.gov.uk> (Cynllunio
Seilwaith Cenedlaethol/National Infrastructure Planning)

Wê / Web: www.gov.uk/government/organisations/planning-inspectorate
(Gwaith achos ac apeliadau/Casework and appeals)

Twitter: [@PINSgov](https://twitter.com/PINSgov)

Nid yw'r cyfartherbiad hwn yn gyfystyr â chyngor cyfreithiol / This
communication does not constitute legal advice.

Edrychwch ar ein [Hysbysiad Preifatrwydd](#) cyn anfon gwybodaeth at yr
Arolygiaeth Gynllunio / Please view our [Privacy Notice](#) before sending
information to the Planning Inspectorate.



This e-mail does not constitute any part of an offer or contract, is confidential and intended solely for the use of the individual(s) to whom it is addressed. If you are not the intended recipient be advised that you have received this email in error and that any use, dissemination, forwarding, printing, or copying of this email is strictly prohibited. Although the firm operates anti-virus programmes, it does not accept responsibility for any damage whatsoever that is caused by viruses being passed. Carter Jonas LLP is a Limited Liability corporate body which has "Members" and not "Partners". Any representative of Carter Jonas LLP described as "Partner" is a Member or an employee of Carter Jonas LLP and is not a "Partner" in a Partnership. The term Partner has been adopted, with effect from 01 May 2005, because it is an accepted way of referring to senior professionals.

Carter Jonas LLP

Place of Registration: England and Wales

Registration Number: OC304417

Address of Registered Office: One Chapel Place, London, W1G 0BG.

Submission on behalf of The Independent Educational Association Limited running and operating the St James Senior Boys School

Plan showing location of the proposed Hockey Pitch to be affected by the Proposed Development

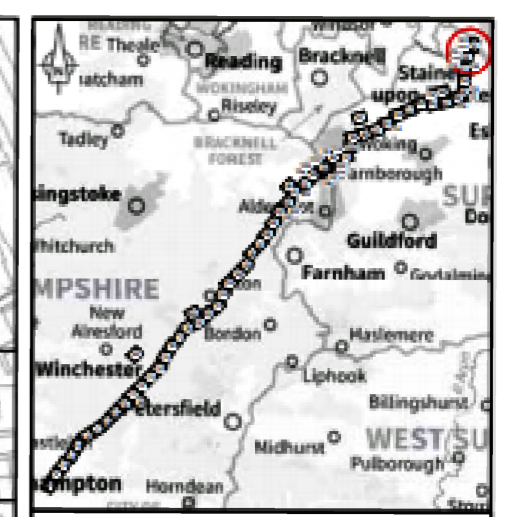
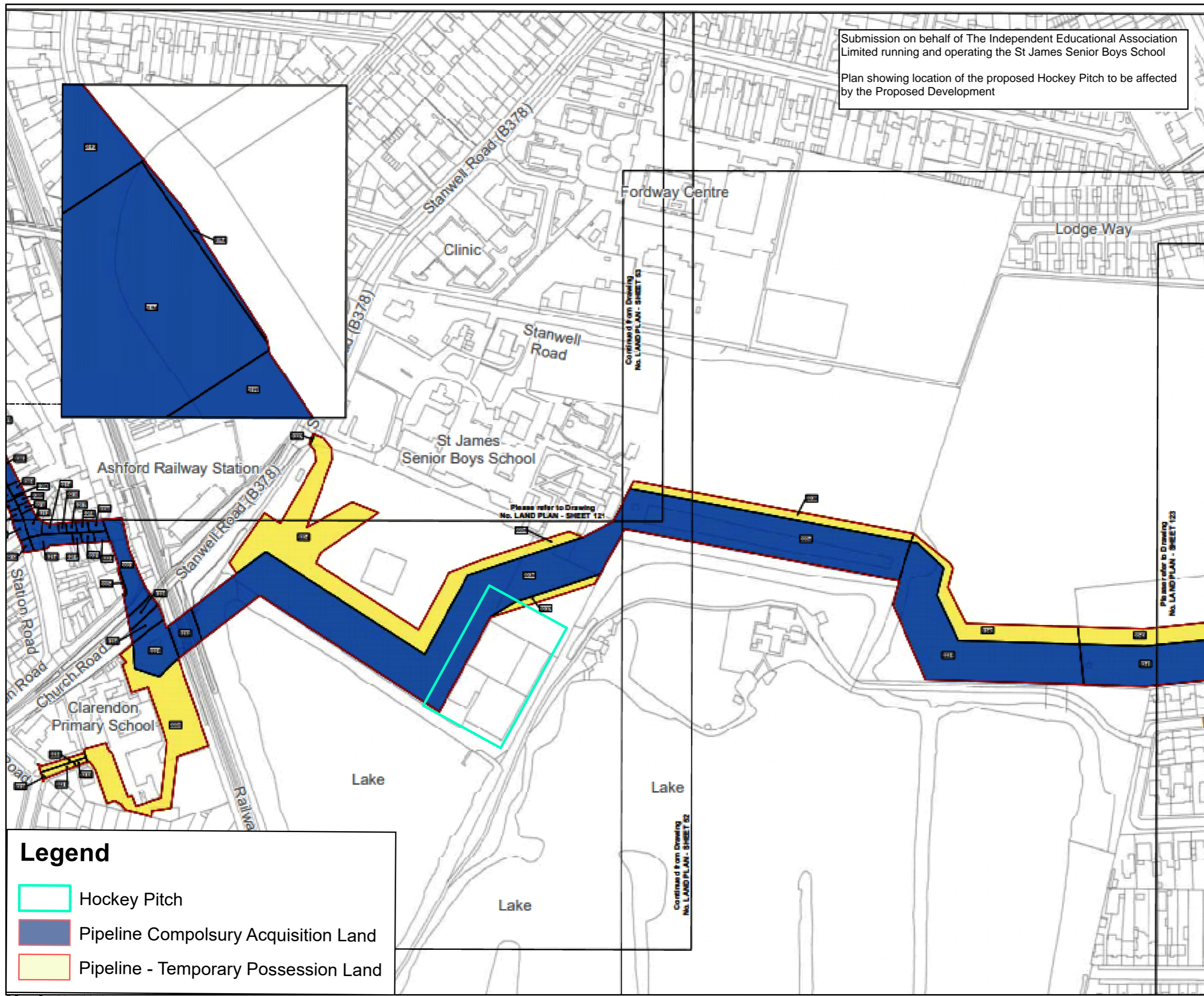

LOCATION PLAN
SCALE 1:500,000

Legend

- Order Limits
- Land subject to compulsory acquisition of all estates and interests as further described in para 5(a) of the Book of Reference
- Land subject to the compulsory acquisition of permanent rights for the pipeline and associated works as further described in para 5(b) of the Book of Reference
- Land subject to compulsory acquisition of permanent rights of access and parking as further described in para 5(c) of the Book of Reference
- Land subject to temporary possession for construction, mitigation, access, etc as further described in para 5(d) of the Book of Reference
- Book of Reference plot label

© Crown copyright and database rights 2019
Ordnance Survey License Number AL100005207

THE DRAWING IS PROTECTED BY COPYRIGHT. IT MAY NOT BE REPRODUCED IN ANY FORM OR BY ANY MEANS FOR ANY PURPOSE WITHOUT WRITTEN PERMISSION OF FISHER GERMAN LLP CHARTERED SURVEYORS.

Rev	Rev. Date	Purpose of Revision	Drawn	Check	Rev'd	Appr'd

The Estates Office, Norman Court
Ashby de la Zouche, Leicestershire, LE65 3UZ
0454 497 0383
efp@fishergerman.co.uk

Client
Esso Petroleum Company, Limited
Essoy House,
Essoy Way,
Leatherhead,
Surrey,
KT22 8LX

Southampton to London
Pipeline Project

Drawing title
**LAND PLAN
SHEET 122
REGULATION 5(2)(g)**
APPLICATION NUMBER: EN57606

Legend

- Hockey Pitch
- Pipeline Compulsory Acquisition Land
- Pipeline - Temporary Possession Land

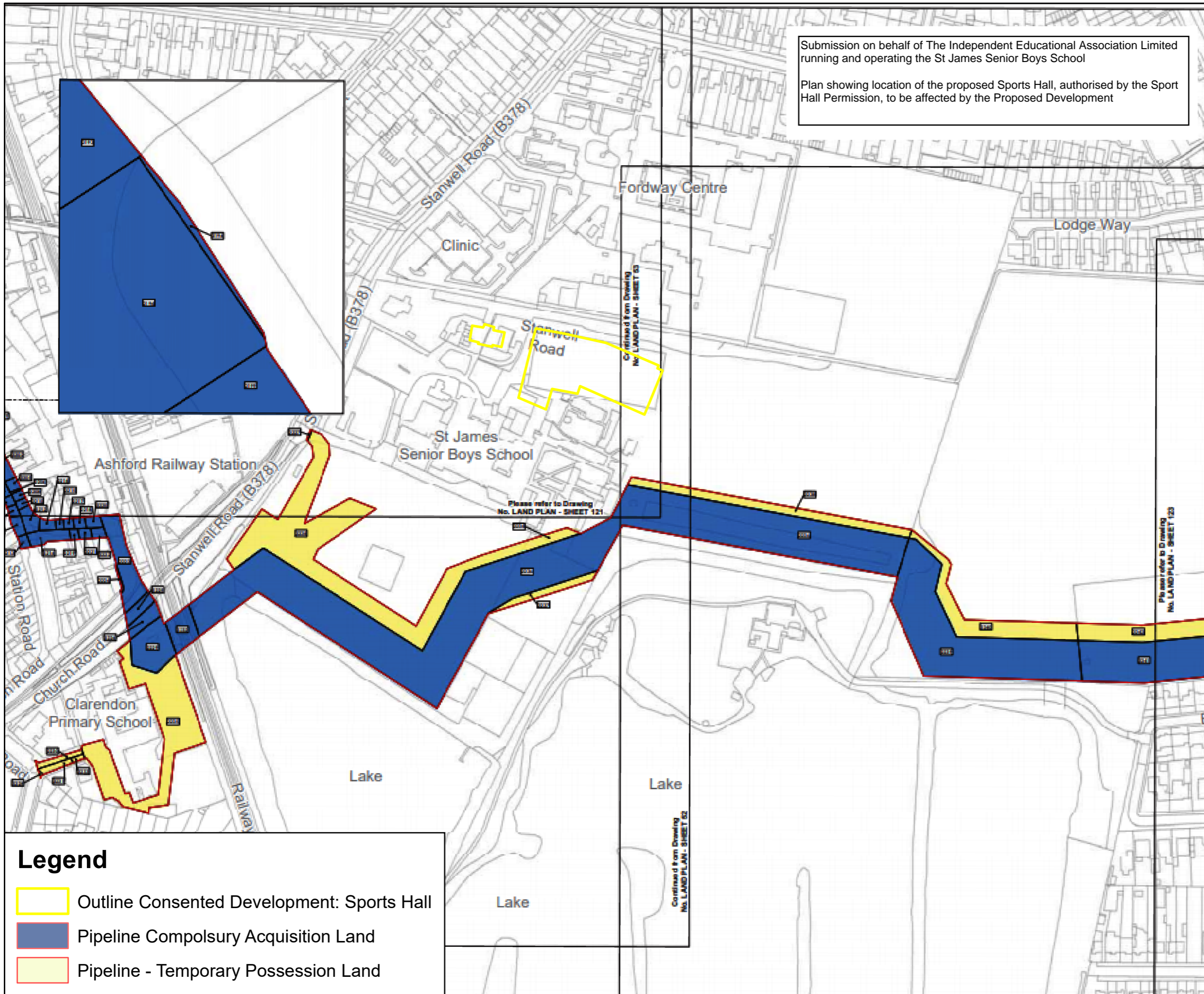

Submission on behalf of The Independent Educational Association Limited running and operating the St James Senior Boys School

Plan showing location of the proposed Sports Hall, authorised by the Sport Hall Permission, to be affected by the Proposed Development



LOCATION PLAN
SCALE 1:500,000

- Legend**
- Order Limits
 - Land subject to compulsory acquisition of all estates and interests as further described in para 5(a) of the Book of Reference
 - Land subject to the compulsory acquisition of permanent rights for the pipeline and associated works as further described in para 5(b) of the Book of Reference
 - Land subject to compulsory acquisition of permanent rights of access and parking as further described in para 5(c) of the Book of Reference
 - Land subject to temporary possession for construction, mitigation, access, etc as further described in para 5(d) of the Book of Reference
 - Book of Reference plot label

- Legend**
- Outline Consented Development: Sports Hall
 - Pipeline Compulsory Acquisition Land
 - Pipeline - Temporary Possession Land

© Crown copyright and database rights 2019
Ordnance Survey Crown Number AL10000458

THIS DRAWING IS PROTECTED BY COPYRIGHT. IT MAY NOT BE REPRODUCED IN ANY FORM OR BY ANY MEANS FOR ANY PURPOSE WITHOUT THE WRITTEN PERMISSION OF FISHER GERMAN LLP CHARTERED SURVEYORS

REV	DATE	DESCRIPTION	BY	CHKD	APPD
001	15/03/19	ISSUED			
002		Prepared for revision			

The Estates Office, Norman Court
Ashby de la Zouch, Leicestershire, LE65 3UZ
0845 437 0383
app@fgm.com

Client
Esso Petroleum Company, Limited
Essoy House,
Essoy Way,
Leatherhead,
Surrey,
KT22 8UX

Project
 Southampton to London Pipeline Project

Drawing title
LAND PLAN SHEET 122 REGULATION 5(2)(b)
APPLICATION NUMBER: EN 070065
Drawing status - FINAL FOR ISSUE

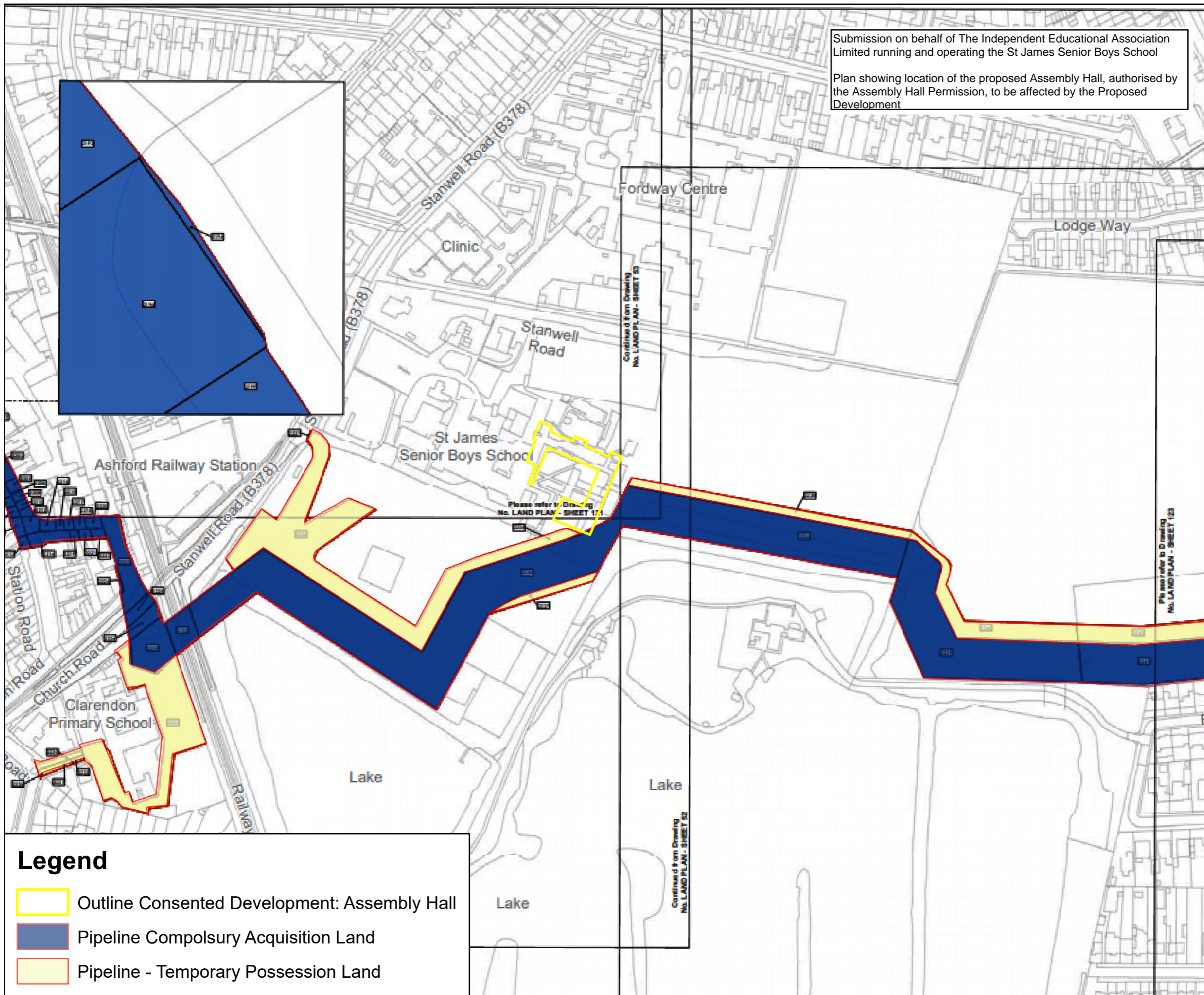

Submission on behalf of The Independent Educational Association Limited running and operating the St James Senior Boys School

Plan showing location of the proposed Assembly Hall, authorised by the Assembly Hall Permission, to be affected by the Proposed Development

Legend

- Outline Consented Development: Assembly Hall
- Pipeline Compulsory Acquisition Land
- Pipeline - Temporary Possession Land



LOCATION PLAN
SCALE 1:500,000

Legend

- Order Limits
- Land subject to compulsory acquisition of all estates and interests as further described in para 5(a) of the Book of Reference
- Land subject to the compulsory acquisition of permanent rights for the pipeline and associated works as further described in para 5(b) of the Book of Reference
- Land subject to compulsory acquisition of permanent rights of access and parking as further described in para 5(c) of the Book of Reference
- Land subject to temporary possession for construction, mitigation, access, etc as further described in para 5(d) of the Book of Reference
- Book of Reference plot label

© Crown copyright and database rights 2018
Ordnance Survey Licence Number AL10000207

THIS DRAWING IS PROTECTED BY COPYRIGHT. IT MAY NOT BE REPRODUCED IN ANY FORM OR BY ANY MEANS FOR ANY PURPOSE WITHOUT WRITTEN PERMISSION OF FISHER GERMAN LLP CHARTERED SURVEYORS

DATE	19/03/19	STATUS	REVISED	BY	ML	APP
REV	Rev. Date	Prepared by/revision	Drawn	Checked	Verified	Approved

The Estates Office, Norman Court
Ashby de la Zouch, Leicestershire, LE65 3UZ
0845 437 0383
app@fishergerman.co.uk

Client
Esso Petroleum Company, Limited
Essoy House,
Essoy Way,
Leatherhead,
Surrey,
KT22 8UX

Project
 Southampton to London Pipeline Project

Drawing title
LAND PLAN
SHEET 122
REGULATION 5(2)(b)

APPLICATION NUMBER: EN 070065

Drawing status: FINAL FOR ISSUE